

THE POWER OF

REDARC®

BMIS 

Battery Master Isolation Switch

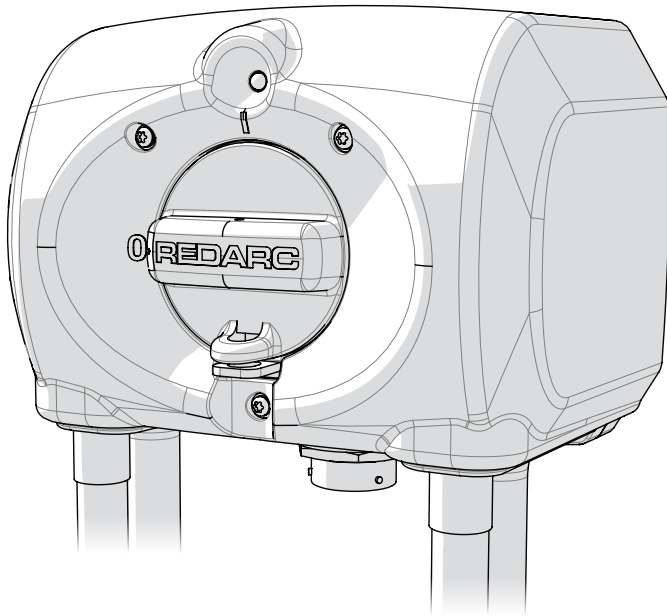

BMIS-4PNV2, BMIS-4PPV2



Compliant with AS 2809.1:2020

THE BATTERY MASTER ISOLATION SWITCH (BMIS)

The Battery Master Isolation Switch (BMIS) allows for manual isolation of a vehicle's (trucks) electrical system from its battery. The BMIS will also ensure that no loads are drawn from the vehicle whilst the vehicle is not in use, thereby reducing flat battery faults. The BMIS models are intended to meet the compliance and specification requirements found in this document and are designed for use with roll over switches or sensors (ROS).

WARNINGS & SAFETY INSTRUCTIONS

SAVE THESE INSTRUCTIONS - THIS MANUAL CONTAINS IMPORTANT SAFETY INSTRUCTIONS FOR THE BMIS. DO NOT OPERATE THE ISOLATION SWITCH UNLESS YOU HAVE READ AND UNDERSTOOD THIS MANUAL AND THE ISOLATION SWITCH IS INSTALLED AS PER THESE INSTALLATION INSTRUCTIONS.

⚠ WARNING

- 1. IT IS OF UTMOST IMPORTANCE THAT YOUR ISOLATION SWITCH BE INSTALLED BY A QUALIFIED INSTALLER AND THE ISOLATION SWITCH FUNCTION BE CHECKED AT LEAST EVERY 3 MONTHS. AN IMPROPERLY INSTALLED AND/OR FAULTY ISOLATION SWITCH CAN CAUSE ERRATIC VEHICLE BEHAVIOUR AND LOSS OF VEHICLE CONTROL.**
- 2. ENSURE THAT THE BMIS IS MOUNTED IN THE ORIENTATION AS DEPICTED. ALTERNATIVE ORIENTATION MAY COMPROMISE CORRECT PRODUCT FUNCTION.**
- 3. ENSURE THAT ALL WIRES ARE TERMINATED CORRECTLY. FAILURE TO CORRECTLY TERMINATE WIRES COULD RESULT IN ERRATIC VEHICLE BEHAVIOUR AND LOSS OF VEHICLE CONTROL, BATTERY FIRE, EXPLOSION OR LEAKAGE.**
- 4. ENSURE THAT THE BMIS SWITCH IS OFF BEFORE INSTALLING THE UNIT. INSTALLING THE BMIS WHILST THE SWITCH IS ON COULD RESULT IN FIRE AND MAY CAUSE INJURY TO PERSONS AND/OR DAMAGE TO PROPERTY.**
- 5. ENSURE THAT THE RED COVER IS INSTALLED, TO PROTECT THE SWITCH MECHANISM FROM ACCIDENTAL OPERATION DUE TO IMPACT OR CORROSION. ACCIDENTAL OPERATION COULD RESULT IN UNEXPECTED POWER ISOLATION AND LOSS OF VEHICLE CONTROL.**
- 6. BMIS 4PPV2 AND 4PNV2 MODELS ARE COMPLIANT WITH AS2809.1:2020 WHEN INSTALLED IN ACCORANCE WITH THAT STANDARD.**

⚠ CAUTION

- 1. Ensure that the cable used to install the BMIS is of adequate gauge to supply the required current to operate the vehicle electrical system. Incorrect wiring can result in fire and may cause injury to persons, damage to the BMIS and/or damage to property.**
- 2. Do NOT alter or disassemble the BMIS under any circumstances. There are no user serviceable parts inside. The BMIS is not serviceable and is lubricated for life. The BMIS must be returned to your supplier for Assessment. Incorrect handling, disassembly or reassembly may result in a risk of electric shock or fire and may void the unit warranty.**

WARNINGS & SAFETY INSTRUCTIONS

NOTICE

1. Ensure that a correct grounding point is used. Poor grounding of the unit will result in poor or no operation.
2. Do NOT use the BMIS to shut off the engine except in an emergency or for routine testing. Use the ignition key as per normal vehicle operation. It is recommended for an engine shutdown test, to perform this on a fully charged battery, or allow a few minutes of engine operation beforehand to recharge the battery as much as possible. Following these recommendations will minimise the possibility of damage or accelerated wear to vehicle electrical systems.
3. Ensure unused holes in the connector are filled with cavity plugs as contamination ingress may damage the BMIS or connector.
4. To prevent contamination ingress, do not insert multiple wires into a single Deutsch connector terminal.
5. For vehicles fitted with SCR / Adblue, it is recommended to restart the truck engine immediately after testing if isolating via the BMIS. Allow 30 seconds minimum or as per the manufacturer's recommendations between key off and isolating the BMIS to allow the SCR system to purge. Refer to the Vehicle manufacturer's manual for further information.

CONTENTS

Table of Contents	Page
Warnings & Safety Instructions	01
Contents	02
Specifications	03
1. Installation	04
1.1 Mounting the BMIS	04
1.2 Wiring Connections	09
1.3 Data Connector Wiring Diagram	10
2 User Guide	11
2.1 Operating the BMIS	12
2.2 LED Indication	12
2.3 Faults	12
2.3.1 LED Fault & Self-test Conditions	12
2.3.2 Flashing LED Diagnosis	12
3. Troubleshooting	13
3.1 Remote Switch	13
3.2 Troubleshooting Flow-chart	13
3.3 Battery Not Charging	14
4. FAQs	14
5. Tech Tips	14
6. Maintenance and Cleaning	15
7. Checking the Product Serial Number	15
8. Standards & Testing	16
9. Notes	17
10. Two Year Warranty	18

SPECIFICATIONS

Part Numbers	BMIS-4PNV2 BMIS-4PPV2
Dangerous Goods Transport	Compliant with AS2809.1:2020 when installed in accordance with that standard
Housing material	GF PBT
Input Voltage	9V to 32V (12V or 24V systems)
Standby Current Draw	<30mA
Ambient Operating Temperature	-20°C to 70°C
Ambient Operating Humidity	0% to 100%
Current Rating (continuous 20°C)	400A per pole
Current Rating (90s, 20°C)	1500A (12% Duty cycle)
Current Rating (20s, 20°C)	3500A per pole
Field Isolation Current Rating	10A Resistive, 5A (field) inductive
Environmental protection	IP66, IP67 & IP69K
Lamp Drive	2W max
Control Inputs (Remote, ROS)	14mA current limited
Weight	3.5kg

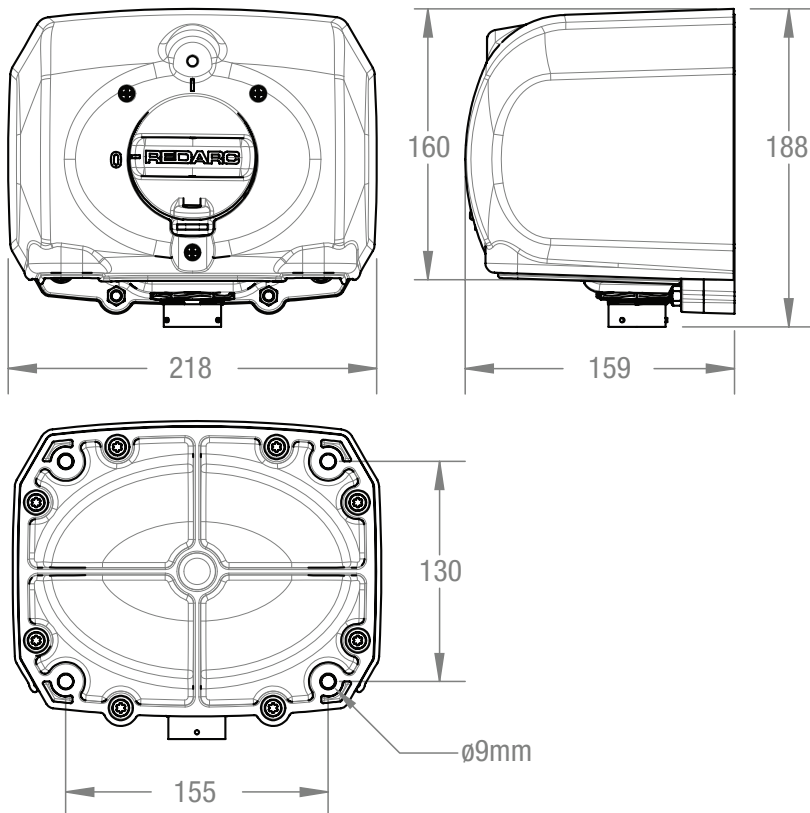

1 INSTALLATION

1.1 Mounting the BMIS

STEP 1.

Bolt the BMIS to a mounting plate with 4 x M8 anti-vibration fasteners and large flat washers as shown (Grade 8.8 minimum). Recommended to use 19mm OD, 1.6mm Flat washer as a minimum size.

TORQUE: 10Nm then 20Nm in a cross pattern (to avoid stressing the housing)

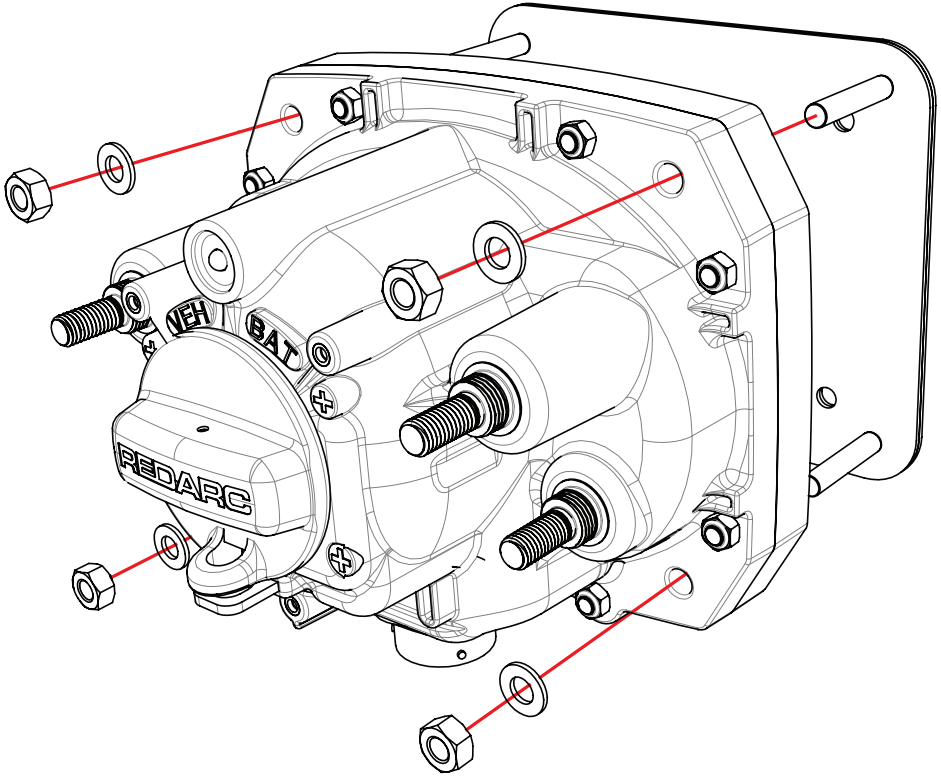

⚠ WARNING

ENSURE THAT SWITCH IS OFF BEFORE INSTALLING THE BMIS UNIT (MARKED '0').
ENSURE THAT THE BMIS IS MOUNTED IN THE ORIENTATION AS DEPICTED ON A FLAT PLANE OR USING THE BMIS-AP. ALTERNATIVE ORIENTATION MAY COMPROMISE CORRECT PRODUCT FUNCTION.

⚠ CAUTION

DO NOT ATTEMPT TO OPEN THE UNIT BY REMOVING THE REAR COVER. THIS UNIT IS NOT SERVICEABLE.

1 INSTALLATION

STEP 2.

Wire the terminal connections in the order shown below.

TORQUE: 20Nm

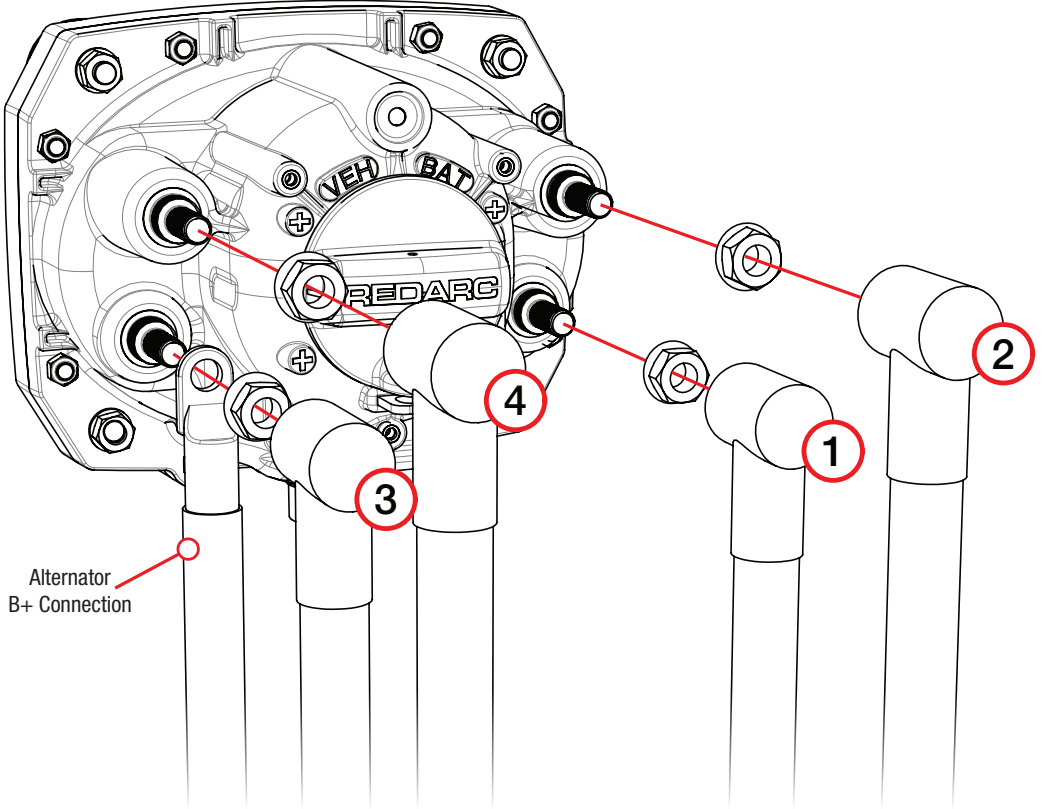

⚠ WARNING

ENSURE THAT ALL WIRES ARE TERMINATED CORRECTLY.
ENSURE THE SWITCH IS IN THE OFF POSITION (MARKED '0') BEFORE COMMENCING THIS STEP.

NOTICE

THE ALTERNATOR B+ CONNECTION IS TO BE CONNECTED TO THE VEHICLE POSITIVE (TERMINAL ③). NO ADDITIONAL WASHERS TO BE USED ON THE TERMINALS. ENSURE CABLES ARE ALIGNED PROPERLY SO THEY DO NOT INTERFERE WITH RED COVER.

STEP 3.

Insert and secure the Data connector, ensuring that pins align correctly before insertion by aligning the guides on the plug housing.

The wiring diagram for the data connector is on page 10.

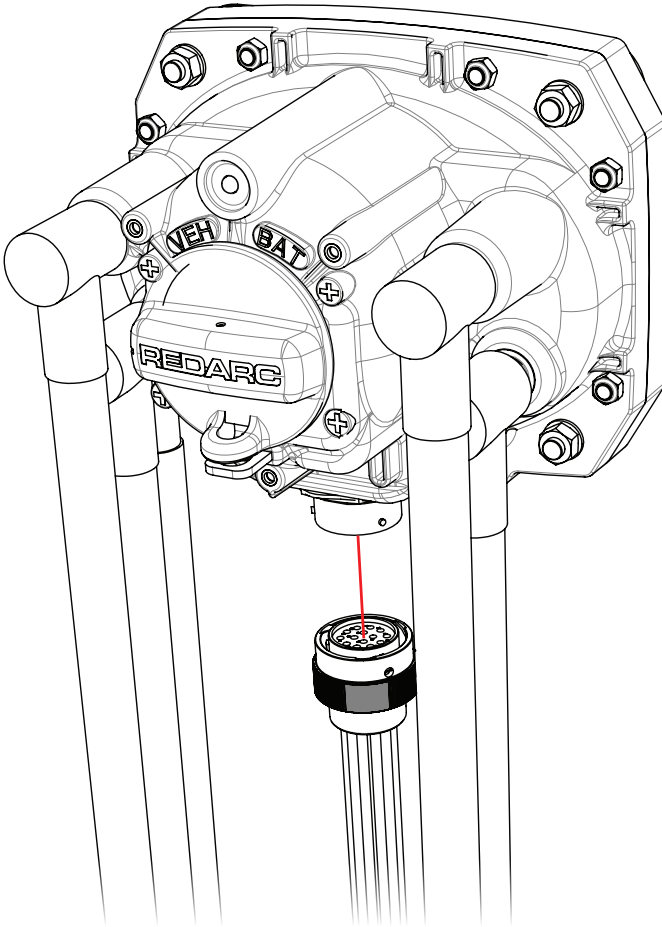

⚠ CAUTION

A SEALING PLUG SHOULD BE USED IF DATA CONNECTOR IS NOT USED. IF ALTERNATOR FIELD WINDING NOT CONNECTED, ACTIVATING THE SWITCH MAY NOT STOP THE ENGINE.

NOTICE

ENSURE THE SWITCH IS IN THE OFF POSITION (MARKED '0') BEFORE COMMENCING THIS STEP.

1 INSTALLATION

STEP 4.

Place cover on unit and secure with 3 x phillips head screws.

TORQUE: 2Nm

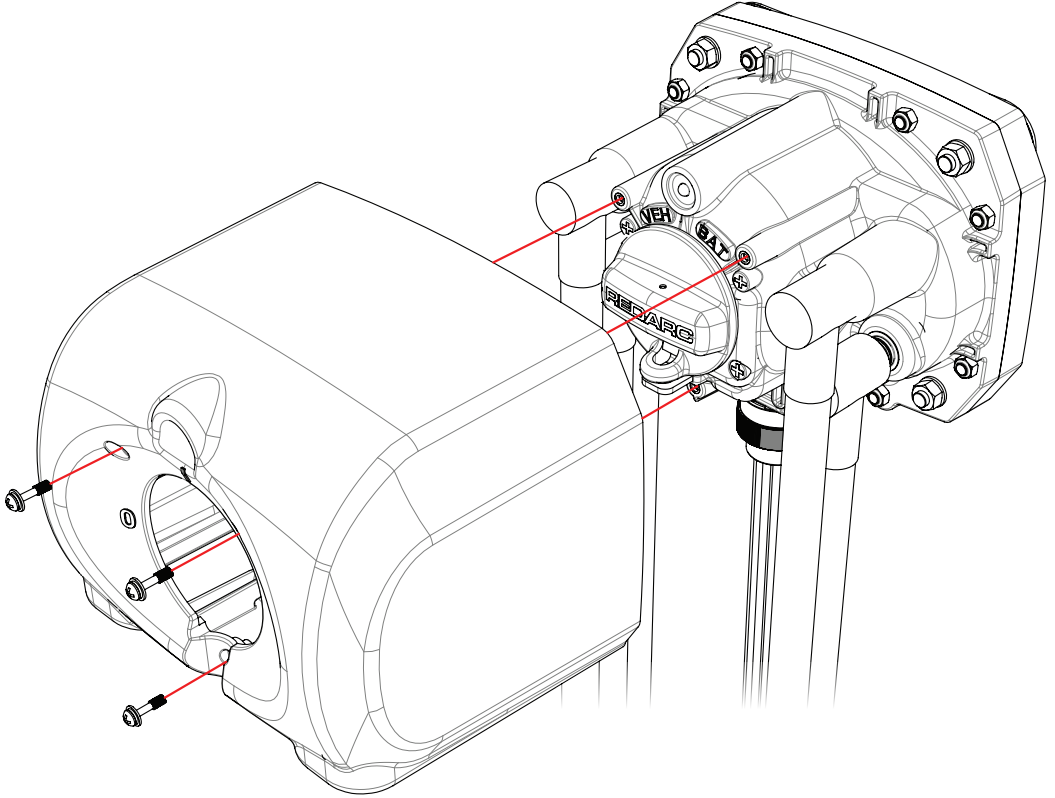

⚠ WARNING

THE RED COVER MUST BE INSTALLED TO PROTECT AGAINST ACCIDENTAL SWITCH ACTIVATION. CONFIRM OPERATION POST INSTALLATION.

1 INSTALLATION

STEP 5.

Install Remote Switch and Roll Over Sensor / Roll Over Switch (ROS) if required. Refer to component supplier instructions.

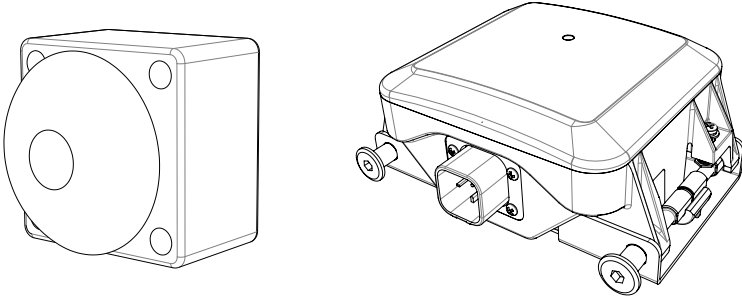

STEP 6.

Test the unit by switching to 'on' position (marked '1') and checking that the indicator LED is lit. The unit should stay in the on position.

- If installed, push the remote switch. This should cause the switch to turn off (marked '0'). The LED will also turn off. Ensure field winding is isolated.
- If installed, Test by following Roll Over Switch (ROS) instructions.

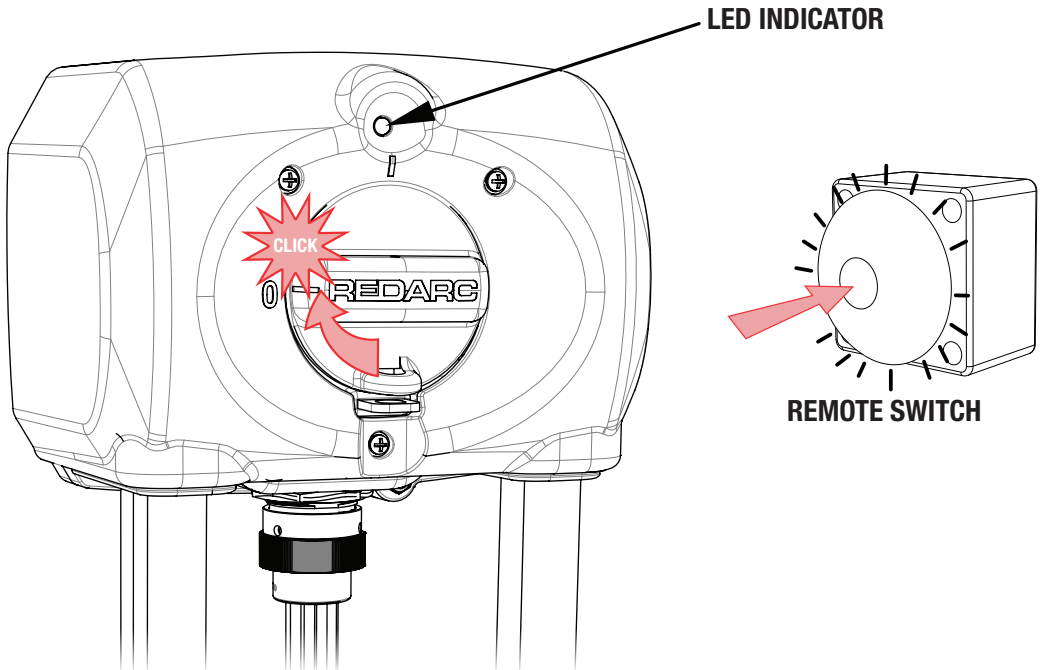

1 INSTALLATION

1.2 Wiring Connections

1.2.1 BMIS-4PNV2

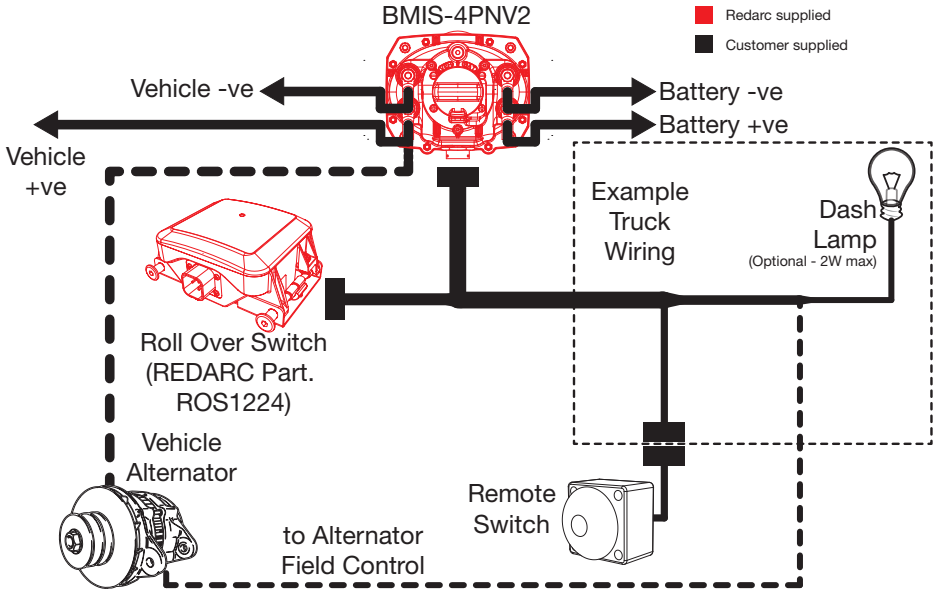

1.2.2 BMIS-4PPV2

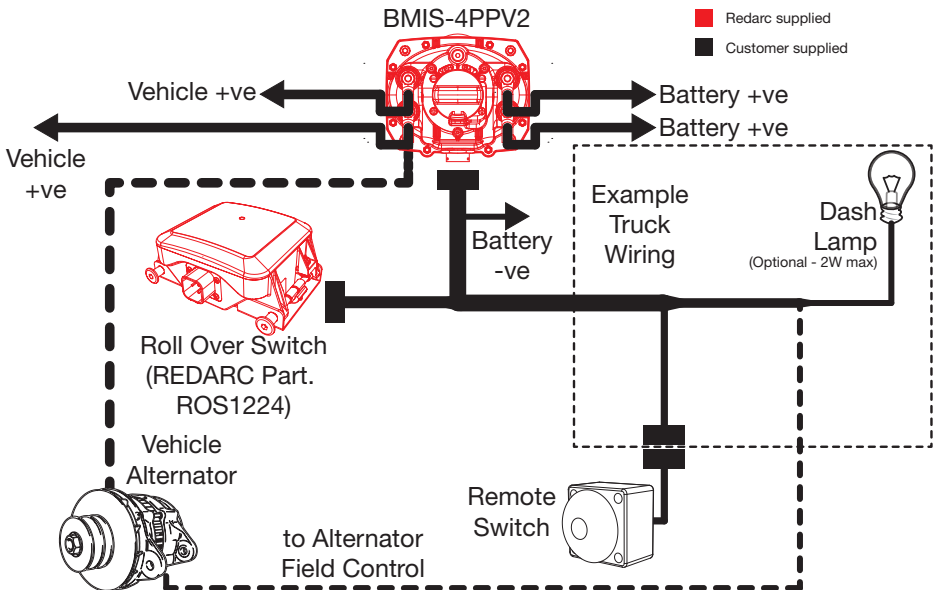

1 INSTALLATION

1.3 Data Connector Wiring Diagram

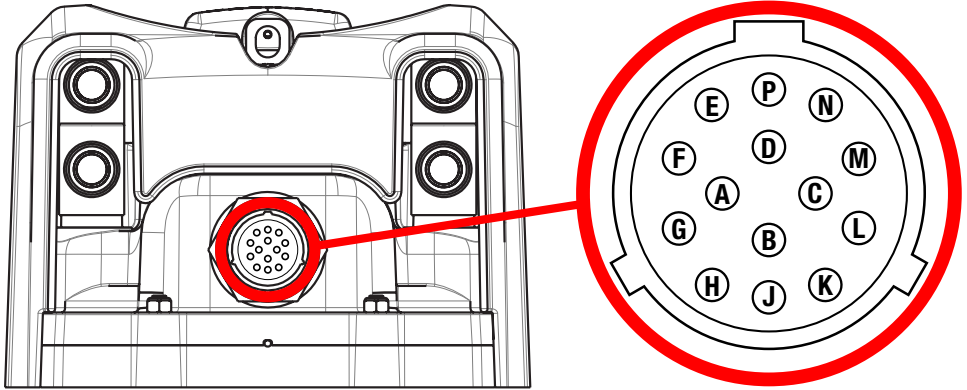

Pin Connections



ABB push button recommended P/N CP6-10R-20 DPST NO switch



Accessories Available

Part number	Description
BMIS-CK	Deutsch Male Connector Kit
BMIS-AP	Big Red/Lucas bolt pattern adapter plate.

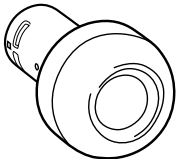
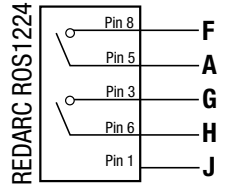
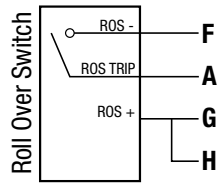
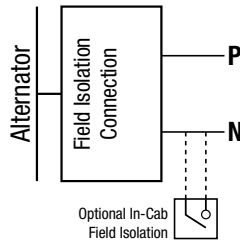
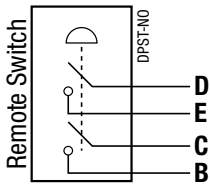
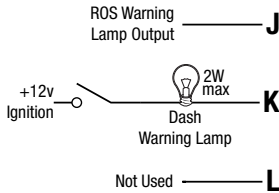
NOTICE

ENSURE UNUSED HOLES IN THE CONNECTOR ARE FILLED WITH CAVITY PLUGS AS CONTAMINATION INGRESS MAY DAMAGE THE BMIS OR CONNECTOR.
DO NOT INSERT MULTIPLE WIRES INTO A SINGLE DEUTSCH CONNECTOR TERMINAL TO PREVENT CONTAMINATION INGRESS.

1 INSTALLATION

BMIS Pin	Function	Recommended Wire Size	Vehicle	Rollover Sensor Connection		
				iROS	Liquip RS400	REDARC ROS1224
M	BMIS-4PPV2 Variant GND or Vehicle negative (connect to chassis)	0.5-1.5mm ² 20-16B&S				
L	Not Used	-				
N	Field Isolation Switch - Normally open (fused 10A max)	2mm ² 14B&S	Alternator field disconnect			
P	Field Isolation Switch – Common (fused 10A max)	2mm ² 14B&S	Alternator field disconnect			
K	Warning Lamp (maximum 2W, fused 1A)	0.5-1.5mm ² 20-16B&S	Warning lamp to Ignition switch positive (optional but recommended)			
C	Remote Switch Supply negative	0.5-1.5mm ² 20-16B&S	Connect via NO switch contact to B			
B	Remote Switch Control Low	0.5-1.5mm ² 20-16B&S	Connect via NO switch contact to C			
D	Remote Switch Control High	0.5-1.5mm ² 20-16B&S	Connect via NO switch contact to E			
E	Remote Switch Supply positive	0.5-1.5mm ² 20-16B&S	Connect via NO switch contact to D			
J	ROS-Data-Warning Lamp Control	0.5-1.5mm ² 20-16B&S		Black (optional)	N/A	PIN 1 (Optional)
H	ROS Control High Trigger Enable	0.5-1.5mm ² 20-16B&S		Connect to pin G	Connect to pin G	PIN 6
A	ROS Control Low Trigger	0.5-1.5mm ² 20-16B&S		Green	White	PIN 5
G	ROS Supply Positive	0.5-1.5mm ² 20-16B&S		Brown	Red	PIN 3
F	ROS Supply Negative	0.5-1.5mm ² 20-16B&S		Blue	Green & Grey	PIN 8

2 USER GUIDE

2.1 Operating the BMIS

TO CONNECT TRUCK POWER:

- Turn the Handle to the 'ON' position (marked '1').
- The LED will be lit.

TO DISCONNECT THE TRUCK POWER

- Turn the Handle to the 'OFF' position (marked '0').
- The LED will not be lit.

2.2 LED Indication

- The LED is ON when the truck power is Connected.
- The LED is OFF when the truck power is Disconnected.
- The LED is flashing when the BMIS is in fault or in self test mode.

2.3.1 LED Fault & Self-test Conditions

Faults are indicated by flashing of the Warning Lamp and the LED on the unit. If the LED is on solid, the unit is working correctly.

Flashing for approximately 2 seconds after the ignition is turned ON and for up to 5 seconds after the isolation switch is turned ON is normal. This indicates the unit is performing a self test and does not indicate a fault.

Flashing at any other time indicates a problem - see section 2.3.2

2.3.2 Flashing LED Diagnosis

If a Roll Over Switch (ROS) is connected, remove the ROS.

- If the flashing stops, there may be an issue with the ROS.

If a remote switch is fitted, disconnect the remote switch and remote switch harness.

- If the flashing stops, there may be an issue with the remote switch or its associated harness.

If the flashing continues the BMIS may be faulty.

- Check inside ROS connectors for moisture ingress - including signs of terminal corrosion and water (droplets).
- Check remote switch for moisture ingress - look for signs of water (droplets), corrosion (on metallic parts and terminals) or 'high tide marks' in enclosures and inside connectors.
- With ROS disconnected and harness disconnected from BMIS (data connector), measure resistance between harness circuits for remote switch and ROS - any 2 circuits measuring less than 100k Ω must be checked for moisture ingress and rectified.
- If LED is not lit, check that you have used the correct part (PN or PP) and that the switch is on.
- If LED remains on after switch is turned off, check that:
 - The battery is connected to the correct side of the switch.
 - All circuits are connected through the BMIS.

3.1 Remote Switch

If the remote switch does not work, check that all four wires are connected to the contacts (DPST type) as per the data connector wiring diagram (figure 1.3). The remote switch will not work if only two wires are connected to a single contact. Do not short wires together when connected to the remote switch, this will render the remote switch inoperable with the Redarc BMIS. When installing or diagnosing the remote switch circuit, Test that a short circuit on either pole of the remote switch does not cause the BMIS to trigger.

3.2 Troubleshooting Flow-Chart

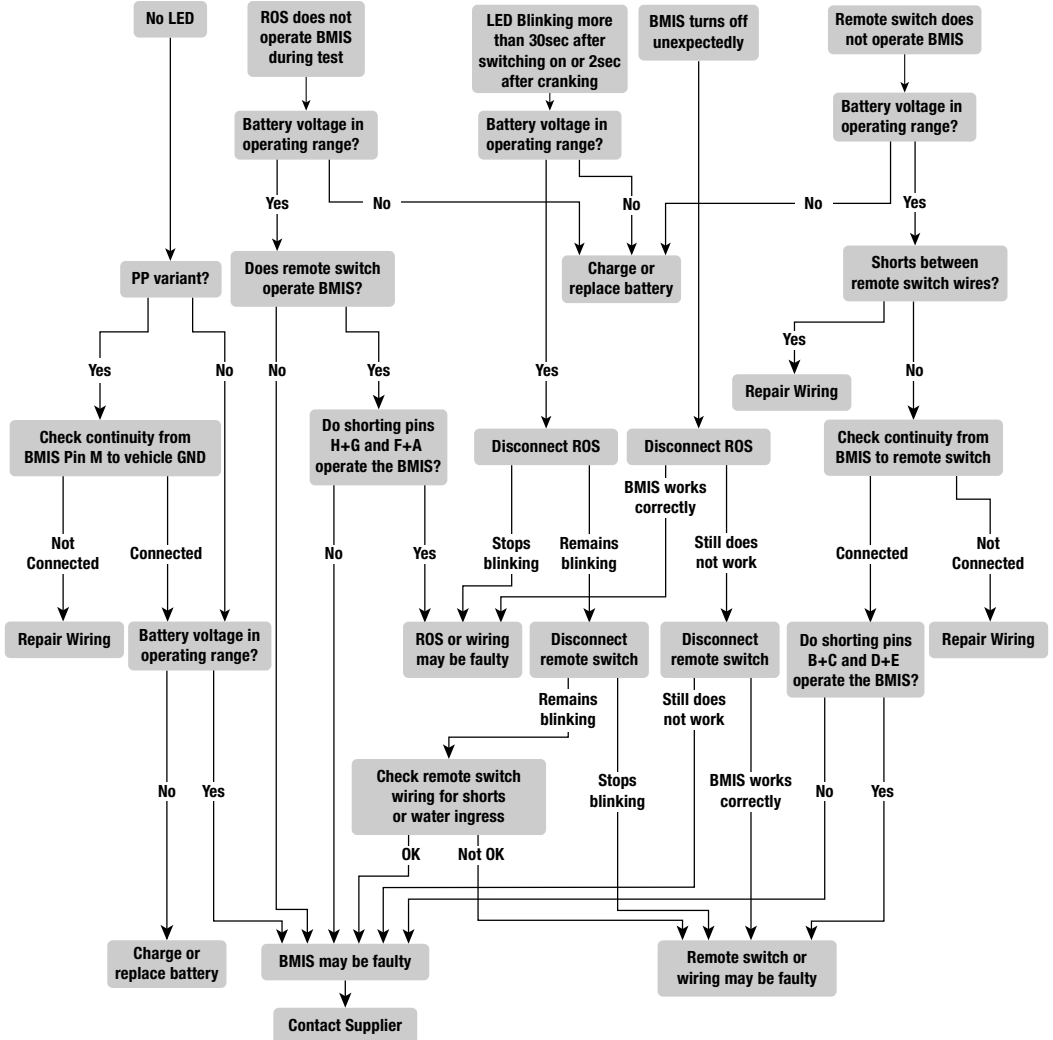

3 TROUBLESHOOTING

3.3 Battery not charging

Check alternator field connections.

- Bridge the field isolation connection at the alternator to verify correct operation.
- Bridge the BMIS harness

4 FAQs

Question: Is the unit protected against voltage spikes?

Answer: Yes, the BMIS incorporates a number of spike protection components specifically designed to reduce the risk of damaging the unit. The BMIS is also designed to prevent any spikes being generated by the unit and in turn affecting any vehicle equipment.

Question: What does the LED indicate?

Answer: The LED indicates the unit is activated and power is available to the vehicle. A flashing red LED indicates a fault except during the first 5 seconds after turning the isolation switch on. See section 2.3.1 on page 12.

Question: Can I use the BMIS to shut off the engine?

Answer: Do NOT routinely use the BMIS to shut off the engine except in an emergency or for routine testing. Use the ignition key as per normal vehicle operation.

It's recommended to perform an engine shutdown test on a fully charged battery (or allow a few minutes of engine operation beforehand to recharge the battery as much as possible). Following these recommendations will minimise the possibility of damage and/or accelerated wear to vehicle electrical systems.

5 TECH TIPS

When mounting - ensure torque in 2 stages, criss-cross method with torque wrench

Do **NOT** install star washers between cable lugs and terminals

Ensure cables are straight and do not interfere with the cover/fascia

Flashing LED - check for water or fault connection in wiring harness

Remote switch requires dual pole to operate the BMIS

Make sure the mating Deutsch connector has blanking plugs installed to prevent potential water ingress

6 MAINTENANCE & CLEANING

If the BMIS is installed or used in dirty conditions, check and clean on a regular basis. Do not open the Unit by removing the rear cover.

Clean the unit with warm, soapy water.

- Do Not high pressure clean.
- Periodically check that the screws and nuts are tight and for correct torque on power on battery and starter motor connections.
- Periodically check isolation switch function in accordance with warnings found on page 1 of this manual.

⚠ CAUTION

DO NOT ALTER OR DISASSEMBLE THE BMIS UNDER ANY CIRCUMSTANCES. THERE ARE NO USER SERVICEABLE PARTS INSIDE. THE BMIS IS NOT SERVICEABLE AND IS LUBRICATED FOR LIFE. THE BMIS MUST BE RETURNED TO YOUR SUPPLIER FOR ASSESSMENT. INCORRECT HANDLING, DISASSEMBLY OR REASSEMBLY MAY RESULT IN A RISK OF ELECTRIC SHOCK OR FIRE AND MAY VOID THE UNIT WARRANTY.

7 CHECKING THE PRODUCT SERIAL NUMBER

The image below indicates where the Product Serial Number is located on the Unit and on the Product Packaging.

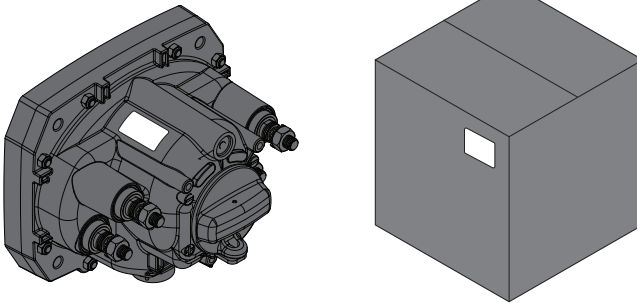

The Serial Number Label contains the Part Number (circled in BLUE below) and the Serial Number (circled in RED below).

The first 4 digits of the serial number indicate the YEAR and MONTH of manufacture, in the form YYMM.



The BMIS -4PPV2 and -4PNV2 are Tested/Certified to:

Reference	Title
AS 2809.1:2020	Road tank vehicles for dangerous goods Part 1: General requirements for all road tank vehicles
IEC 60529 IP66/67	Degree of protection provided by enclosures
UL94	Tests for flammability of plastic materials for parts in devices and appliances
AS/NZS CISPR 11 GROUP 1 CLASS A	Industrial, scientific and medical (ISM) RF equipment electromagnetic disturbance characteristics.
ISO60068-2-74 (MOD) ISO 8092-2	Resistance to automotive fluids
SAE J1113-11,-12 ISO 7637-2 ISO 11452-10	Electrical transients for electrical and electronic devices
SAE J1113-4,-21 ISO 11452-2,-4	Electromagnetic-radiated-immunity requirements for electrical and electronic components
CISPR25 (MOD) CLASS 3	Electromagnetic-radiated emissions for electrical and electronic components
IEC 60068-2-30 IEC 60068-2-38	Humidity testing for electrical components
ISO 60068-2-2	Accelerated temperature aging test for electrical and electronic components
ASTM D3170	Gravel bombardment test for electrical and electronic components
ASTM B117 1000Hrs	Salt-fog test for electrical and electronic components
ISO 16750-3 IEC 60068-2-64 TEST VII	Vibration requirements for electrical/electronic devices, Commercial Vehicle 6g
ISO 10605	Electrostatic discharge (ESD) immunity test requirements
IEC 60068-2-14 ISO 16750-4	Temperature cycling test for electrical and electronic components
IEC 60068-2-2 ISO 16750-4	High temperature test for electrical and electronic components
IEC 60068-2-1 ISO 16750-4	Low temperature test for electrical and electronic components

10 TWO YEAR PRODUCT WARRANTY

Over the last four decades our company has established a reputation as the power conversion specialist.

A 100% Australian-owned company, we have met the needs of customers in transport and other industries through exciting, innovative thinking.

We believe in total customer satisfaction and practice this by offering our customers:

- Technical advice free of jargon and free of charge
- Prompt turnaround of orders throughout Australia and globally
- Friendly, personalised, professional service and product support

In the unlikely event that a technical issue arises with a Redarc product, customers are encouraged to initially contact the Redarc Technical Support Team on (08) 8322 4848 or power@redarc.com.au for prompt and efficient diagnosis and product support.

Our goods come with guarantees that cannot be excluded under the Australian Consumer Law. You are entitled to a replacement or refund for a major failure and compensation for any other reasonably foreseeable loss or damage. You are also entitled to have the goods repaired or replaced if the goods fail to be of acceptable quality and the failure does not amount to a major failure.

The benefits of this Warranty are in addition to other rights and remedies available at law in respect of the Products and shall not derogate from any applicable mandatory statutory provisions or rights under the Australian Consumer Law.

Redarc Electronics Pty Ltd aff the Redarc Trust trading as Redarc Electronics ("Redarc") offers a warranty in respect of its Products where the Products are purchased from an authorised distributor or reseller of Redarc by a person ("Purchaser"), on the terms and conditions, and for the duration, outlined below in this document ("Warranty").

1. In this Warranty, the term **Products** means:

- 1.1 all products manufactured or supplied by Redarc (excluding its solar products which are covered by Redarc's Solar Product Warranty); and
- 1.2 any component of or accessory for any product in clause 1.1 manufactured or supplied by Redarc.

Offer and duration of product warranties

2. Redarc warrants that its Products will be free, under normal application, installation, use and service conditions, from defects in materials and workmanship affecting normal use, for **2 years** from the date of purchase (**Warranty Period**).
3. Where a Product malfunctions or becomes inoperative during the Warranty Period, due to a defect in materials or workmanship, as determined by Redarc, then subject to further rights conferred by the Australian Consumer Law on the Purchaser, Redarc will, in exercise of its sole discretion, either:
 - 3.1 repair the defective Product;
 - 3.2 replace the defective Product; or
 - 3.3 provide a refund to the Purchaser for the purchase price paid for the defective Product, without charge to the Purchaser.
4. The warranty given by Redarc in clause 3 covers the reasonable costs of delivery and installation of any repaired or replaced Products or components of Products to the Purchaser's usual residential address notified to Redarc, together with the reasonable costs of removal and return of any Products determined by Redarc to be defective.
5. If the Purchaser incurs expenses of the nature referred to in clause 4 in the context of making a claim pursuant to this Warranty that is accepted by Redarc, the Purchaser will be entitled to claim for reimbursement of those expenses which Redarc determines, in exercise of its sole discretion, to be reasonably incurred, provided that the claim is notified to Redarc in writing at the postal address or email address specified in clause 21 and includes:
 - 5.1 details of the relevant expenses incurred by the Purchaser; and
 - 5.2 proof of the relevant expenses having been incurred by the Purchaser.

Exclusions and limitations

6. This Warranty will not apply to, or include any defect, damage, fault, failure or malfunction of a Product, which Redarc determines, in exercise of its sole discretion, to be due to:
 - 6.1 normal wear and tear or exposure to weather conditions over time;
 - 6.2 accident, misuse, abuse, negligence, vandalism, alteration or modification;
 - 6.3 non-observance of any of the instructions supplied by Redarc, including instructions concerning installation, configuring, connecting, commissioning, use or application of the Product, including without limitation choice of location;
 - 6.4 failure to ensure proper maintenance of the Product strictly in accordance with Redarc's instructions or failure to ensure proper maintenance of any associated equipment or machinery;
 - 6.5 repairs to the Product that are not strictly in accordance with Redarc's instructions;
 - 6.6 installation, repairs or maintenance of the Product by, or under the supervision of, a person who is not a qualified auto electrician or technician, or if non-genuine or non-approved parts have been fitted;
 - 6.7 faulty power supply, power failure, electrical spikes or surges, lightning, flood, storm, hail, extreme heat, fire or other occurrence outside the control of Redarc;
 - 6.8 use other than for any reasonable purpose for which the Product was manufactured;
 - 6.9 any indirect or incidental damage of whatever nature outside the control of Redarc.
7. Warranty claims in respect of a Product must be made in writing to Redarc at the postal address or email address specified in clause 21 within the Warranty Period. Such claims must include the following:
 - 7.1 details of the alleged defect or fault and the circumstances surrounding the defect or fault;
 - 7.2 evidence of the claim, including photographs of the Product (where the subject of the claim is capable of being photographed);
 - 7.3 the serial number of the Product, specified on the label affixed to the Product; and
 - 7.4 proof of purchase documentation for the Product from an authorised distributor or reseller of Redarc, which clearly shows the date and place of purchase.The return of any Products without the prior written instructions of Redarc will not be accepted by Redarc.

8. Without limiting any other clause in this Warranty, Redarc has the right to reject any Warranty claim made by a Purchaser pursuant to this Warranty where:

- 8.1 the Purchaser does not notify Redarc in writing of a Warranty claim within the Warranty Period;
- 8.2 the Purchaser does not notify Redarc in writing of a Warranty claim within 1 month of becoming aware of the relevant circumstances giving rise to the claim, so that any further problems with the Product are minimised;
- 8.3 the serial number of the Product has been altered, removed or made illegible without the written authority of Redarc;
- 8.4 the Purchaser is unable to provide proof of purchase documentation in accordance with clause 7.4 or evidence that the Product was properly installed and removed (if relevant), and that proper maintenance has been performed on the Product, by, or under the supervision of, a qualified auto electrician or technician, in accordance with the instructions of Redarc.
9. If the Product is found to be working satisfactorily on return to Redarc or upon investigation by Redarc, the Purchaser must pay Redarc's reasonable costs of testing and investigating the Product in addition to shipping and transportation charges. Where Redarc is in possession of the Product, the Product will be returned to the Purchaser on receipt of the amount charged.
10. Any replaced Products or components of Products shall become the property of Redarc.
11. Redarc may, in exercise of its sole discretion, deliver another type of Product or component of a Product (different in size, colour, shape, weight, brand and/or other specifications) in fulfilling its obligations under this Warranty, in the event that Redarc has discontinued manufacturing or supplying the relevant Product or component at the time of the Warranty claim, or where such Product or component is superior to that originally purchased by the Purchaser.

Other conditions of Warranty

12. If the Purchaser acquired a Product for the purpose of resupply, then this Warranty shall not apply to that Product.
13. In particular, the sale of a Product via an online auction, online store or other internet website by a party that is not an authorised distributor or reseller of the Product will be deemed to be a resupply within the meaning of the Australian Consumer Law and will render this Warranty void, as Redarc has no control over the storage, handling, quality or safety of Products sold by such persons.
14. A Purchaser shall only be entitled to the benefit of this Warranty after all amounts owing in respect of the Product have been paid.
15. While Redarc warrants that the Products will be free from defects in materials and workmanship in the circumstances set out in this Warranty, to the maximum extent permitted by law Redarc does not warrant that the operation of the Products will be uninterrupted or error-free.
16. To the maximum extent permitted by law, Redarc's determination of the existence of any defect and the cause of any defect will be conclusive.
17. Spare parts or materials for the Products are guaranteed to be available for a period of at least 2 years after purchase of the Products.
18. The agents, officers and employees of any distributor or reseller of the Products and of Redarc are not authorised to vary or extend the terms of this Warranty.
19. Redarc shall not be responsible or liable to the Customer or any third party in connection with any non-performance or delay in performance of any terms and conditions of this Warranty, due to acts of God, war, riots, strikes, warlike conditions, plague or other epidemic, fire, flood, blizzard, hurricane, changes of public policies, terrorism and other events which are beyond the control of Redarc. In such circumstances, Redarc may suspend performance of this Warranty without liability for the period of the delay reasonably attributable to such causes.
20. If a clause or part of a clause in this Warranty can be read in a way that makes it illegal, unenforceable or invalid, but can also be read in a way that makes it legal, enforceable and valid, it must be read in the latter way. If any clause or part of a clause in this Warranty is illegal, unenforceable or invalid, that clause or part is to be treated as removed from this Warranty, but the rest of this Warranty is not affected.

Redarc's contact details

21. Redarc's contact details for the sending of Warranty claims under this Warranty are:
REDARC Electronics Pty Ltd
23 Brodie Road (North), Lonsdale SA 5160
Email: power@redarc.com.au
Telephone: +61 8 8322 4848

THE POWER OF
REDARC[®]

Free technical assistance!

please contact

REDARC Electronics

23 Brodie Road North, Lonsdale SA

+61 8 8322 4848

power@redarc.com.au

www.redarc.com.au

Copyright © 2020 REDARC Electronics Pty Ltd. All rights reserved.